

Babraham

SUMMER 2019

New development in Babraham/ nr Sawston

Planning permission for H1/B development on our border with Sawston has been approved for 158 dwellings, a number that we consider more in line with an urban development and not a rural one. Sawston, supported by ourselves have requested a "call in" where the Secretary of state will review the housing density. If the current density is maintained we have negotiated for s106 money, a amount required by the developer to pay to compensate for additional pressure on current facilities, and £72K, plus £20K for internals, will go towards a village hub/hall.

Traffic calming

Due to the extremely high cost of traffic calming we have decided to submit an application to highways for an assisted purchase, a PFHI, and installation of speed bumps, and strategic line marking to reduce flow problems at the school.

Dog walking

The dog poo bin in church lane will have been supplemented by a second bin to hopefully avoid unsightly overflow. The number of dog walkers in this area has increased greatly over the last year but are pleased to see that the bins are being used responsibly. So far so good.

Pocket Park

The pocket park remains tidy and used by residents and passers-by. For the bird enthusiasts kingfishers have seen near the church area of the river.

Neighbourhood plan

The plan continues under guidance of Cllr Rob Attwood. If you have any input or queries please feel free to contact him.



Jonas Webb

The statue of Jonas Webb has been cleared of overhanging branches and now stands in full glory overlooking the village.

Resurfacing of path to Church Road

We would like to thank the Babraham Campus for resurfacing of the tarmac path over the footbridge to the church. It had become very uneven due to tree root growth.

Defibrillator

We are now the proud owners of a defibrillator but have nowhere to site it. We are in discussion with Greene King to attach the apparatus to the kitchen part of the George but because the building is listed, we require GK to instigate permission. This is proving very slow process. We will persist

A1307 junction with Babraham High Street

It looks likely that as part of the upgrade of the A1307 changes

will be made to the junction. It will be left turn only from the High Street in the hope that the number of traffic accidents will decrease. It may also assist exit from the high street into the seemingly endless morning traffic. There will also be a 50 mph speed limit imposed along that stretch of the A1307.

Parish council meetings

Just a reminder that the monthly meetings of the Parish Council are open to all. There is an opportunity for non-council members to speak, and the meetings are conducted in an informal manner. Please feel free to attend. They are held on the 2nd Thursday of each month (excluding December)

We are your voice on local matters so please let us know how, in your opinion, we can improve or indeed maintain our lovely village.



Monday: Lynton Way, Sawston - 6.30pm

Wednesday: Lynton Way, Sawston - 6.30pm

Thursday: The George, Babraham - 9.30am
Lynton Way, Sawston - 7pm

Angela will put you
through your paces
07799 696815



Park & Ride and designated busway

There will be a park and ride situated around the A11 roundabout area. It has yet to be decided but two of the sites our in our Parish. See below the three sites, A and B are the two in our Parish the other C is just before the 4 lamps roundabout. I hope that is clear from the map. The blue, black, red and green lines are the routes the buses will take. It's a new bus route with a cycle path running next to it. This will

not only cut through the fields in our parish (blue line) or around the edge of the fields quite near to the old railway line route (Red/black/green line) . . . but will then go on passed Sawston and on to Stapleford and Shelford where it may well cut through all those lovely fields between them and the A1307, continuing over the hill towards Nine Wells and eventually the hospital site.

Not a pretty thought and very ugly . . . this will happen in some form or other I have made it pretty clear the Blue line route is partially dreadful but we need as many people as possible to give their views. Public consultation will be around later in the year. There are a few years before this gets under way so there is time to fight for a better option/solution.

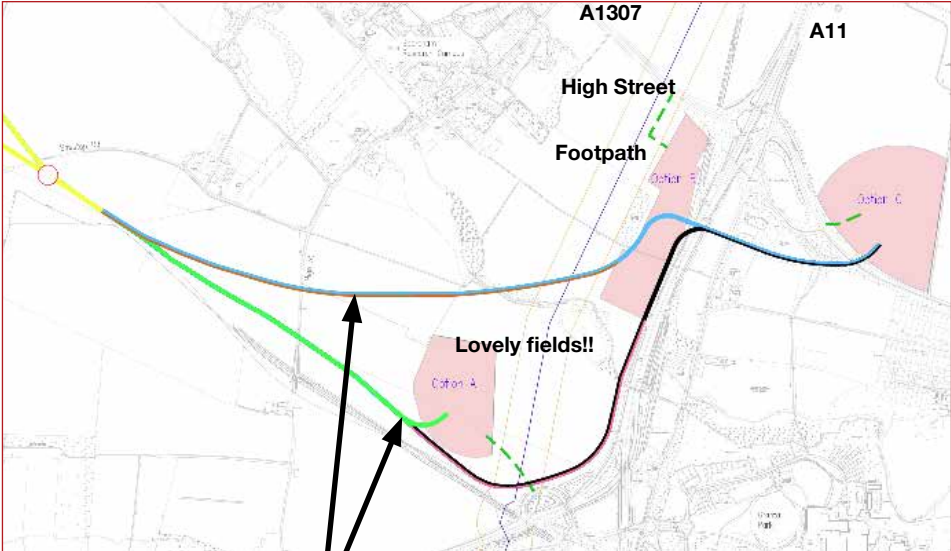

This busway will go on one of these options

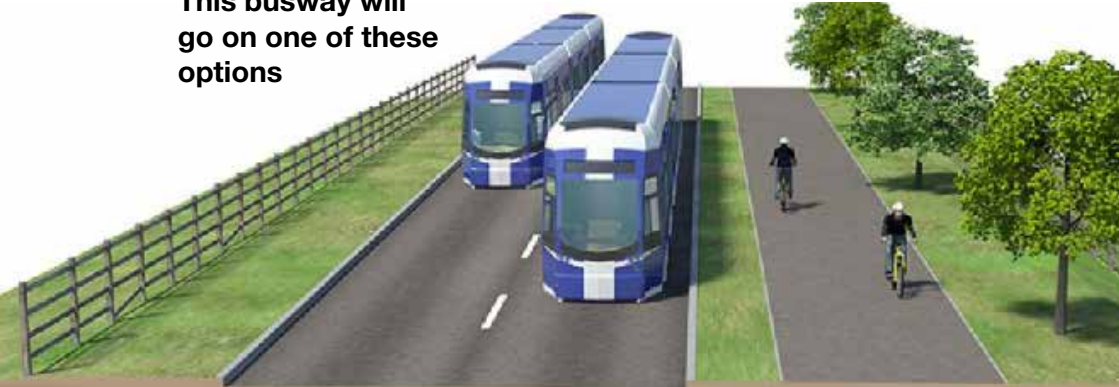

The junction to the A1307

The alterations to the junction from the High Street onto the 1307 will take place towards the end of the year hopefully in December. It's a shame it can't be sooner as there have been two pretty bad accidents in recent weeks, this being the beginning of June. It will be a lot safer. All that you can see in the diagram below is planned and will change.

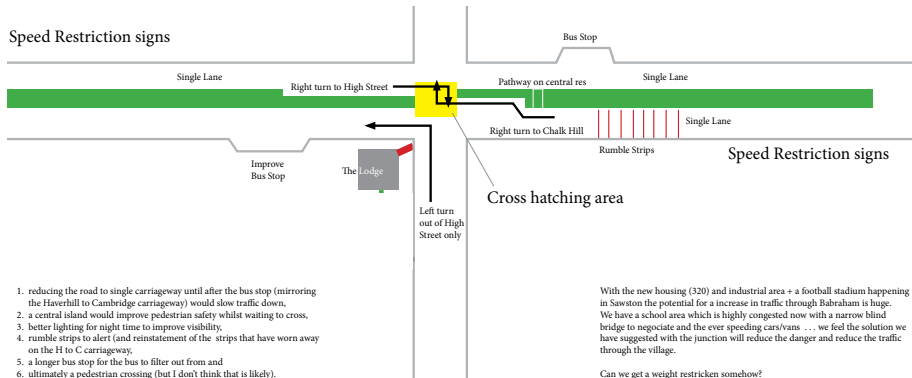

1. reducing the road to single carriageway until after the bus stop (mirroring the Havertill to Cambridge carriageway) would slow traffic down,
2. a central island would improve pedestrian safety whilst waiting to cross,
3. better lighting for night time to improve visibility,
4. rumble strips to alert (and reinstatement of the strips that have worn away on the H to C carriageway,
5. a longer bus stop for the bus to filter out from and
6. ultimately a pedestrian crossing (but I don't think that is likely).

Some simple maintenance would be useful (it is difficult to see oncoming traffic when turning right into the village because of the height of the grass).

With the new housing (320) and industrial area + a football stadium happening in Sawston the potential for an increase in traffic through Babraham is huge. We have a school area which is highly congested now with a narrow blind bridge to negotiate and the ever speeding cars/vans ... we feel the solution we have suggested with the junction will reduce the danger and reduce the traffic through the village.

Can we get a weight restricted somehow?

Village Spring Breakfast

Followed by a River walk was a real success and a big thank you to all how made that happen



Fire . . . *Fire!*



There I was sitting quietly in my Room of Requirement when my daughter said why have we got blue flashing lights down Honeysuckle . . . there I was gone . . . down the garden like a bat outta hell thinking my shed/ car was on fire only to find that Babraham had got its own version of the 'burning bush' . . . mind you there were a lot of firemen about and if it hadn't been for the eagle eyed Emily

Morris who knows what might have happen . . . The Great Fire of etc etc. Emily phoned the brigade immediately and within seconds they were there (they had been out on a training exercise and were passing) and soon the tree was extinguished a shadow of its former self . . . and Paul's newly planted allotment garden got a good watering, bit of a coincidence that!

Colour Festival



Great day . . . the runners ran . . . the food was ate . . . the sun shone and the band played on!





**G A Construction &
Groundworks Ltd**

Driveways, Patios, Block Paving, Fencing & all aspects of
groundworks.

Call for your free no obligation quote - Tel: 01223 977691 / 07595
120206

www.gaconstruction.com

Useful Contacts

Parish Council

Stuart Laurie

stuart.laurie@babraham-village.net

Charlotte Rogers

charlotte.rogers@babraham-village.net

Jane Goody

jane.goody@babraham-village.net

Gareth Walker

gareth.walker@babraham-village.net

Robert Attwood

robert.attwood@babraham-village.net

Don Powell

clerk@babraham-village.net

South Cambs Councillors

Kevin Cuffley and Roger Hickford

District Councillor

Peter McDonald

The Parish Council meets on the second Thursday every month at the school 7.30. Members of the public are more than welcome to attend.

www.babrahamschool.org.uk

www.babraham-village.net

 [@babrahamvillage](https://twitter.com/babrahamvillage)